

SkillsUSA

CALIFORNIA

STATE CONTEST

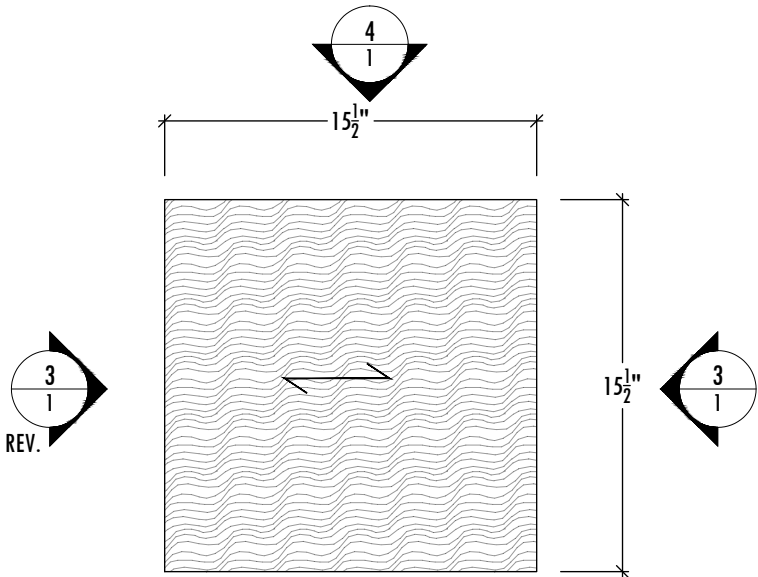

1 PLAN VIEW
SCALE: $1\frac{1}{2}" = 1'-0"$

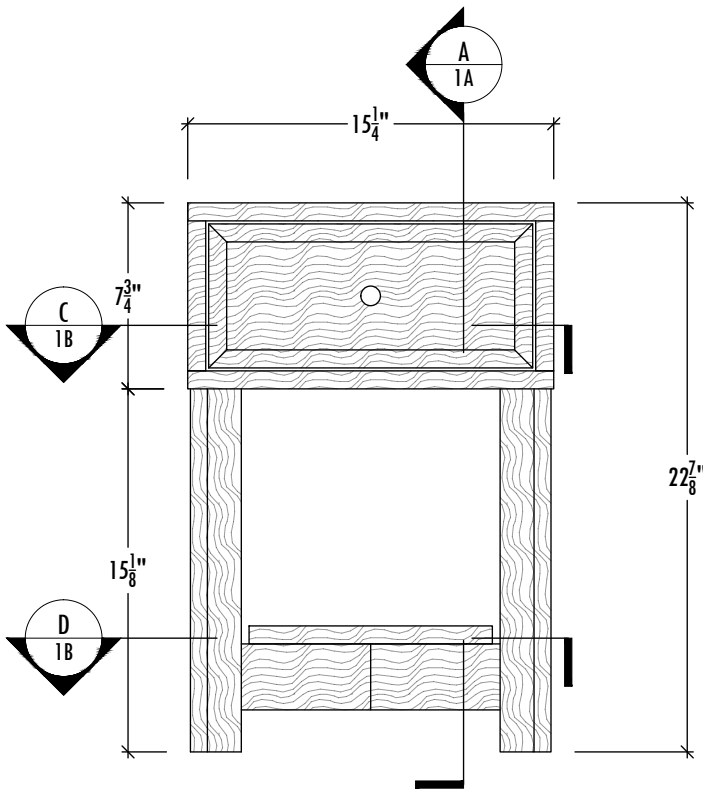

2 ELEVATION
SCALE: $1\frac{1}{2}" = 1'-0"$

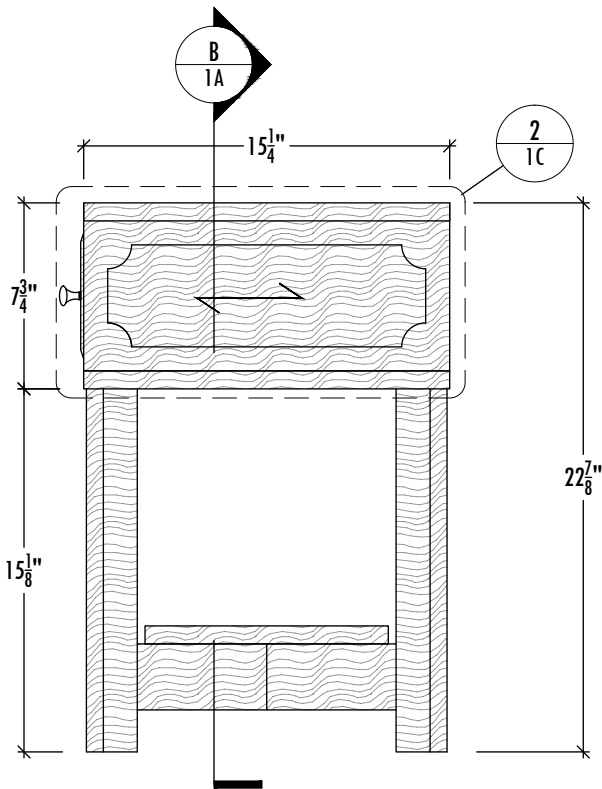

3 ELEVATION
SCALE: $1\frac{1}{2}" = 1'-0"$

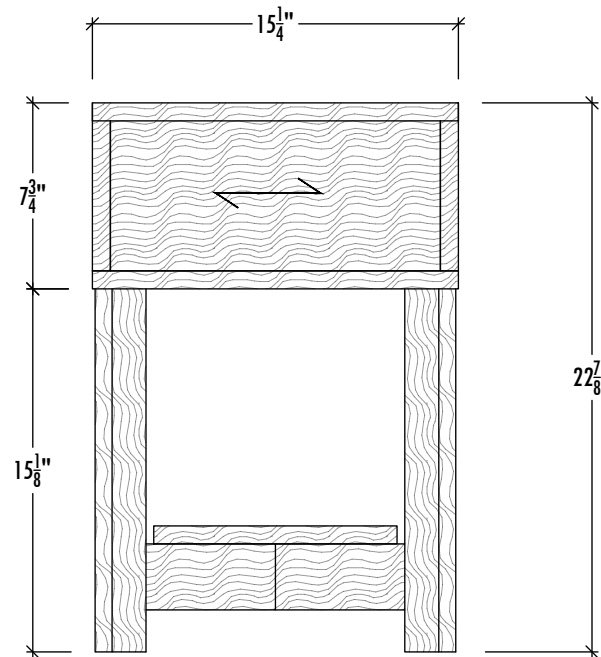

4 ELEVATION
SCALE: $1\frac{1}{2}" = 1'-0"$

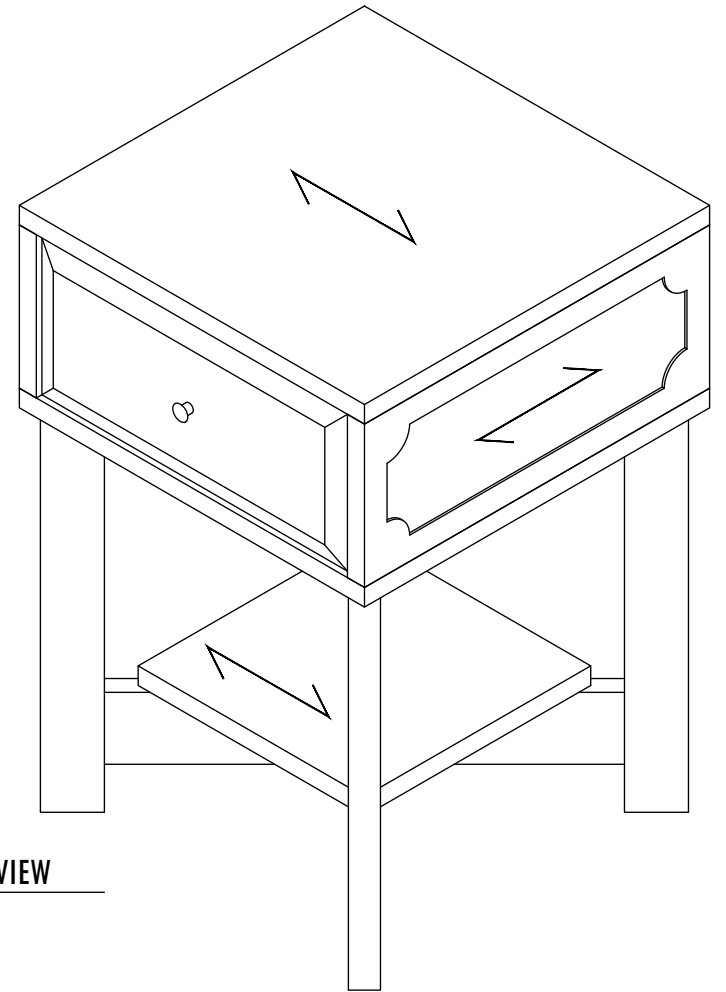

ISOMETRIC VIEW
SCALE: NTS

CONTESTANT #

SkillsUSA
CALIFORNIA
STATE CONTEST

ITEM: WOOD END TABLE	
DATE: APRIL	2025
SCALE: AS SHOWN	DWG #: 1
DRAWN BY: DW	

SPECIAL SPONSORS:

Duckworks
Millwork Solutions

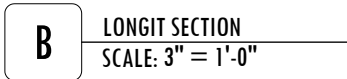
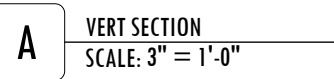

<h1 style="margin: 0;">SkillsUSA</h1> <h2 style="margin: 0;">CALIFORNIA STATE CONTEST</h2>	
ITEM: WOOD END TABLE	
DATE: APRIL	COMPETITION DATE: 2025
SCALE: 3" = 1'-0"	DWG #: 1A
DRAWN BY: DW	
SPECIAL SPONSORS:	
 <p style="margin-top: 10px; font-weight: bold;">Millwork Solutions</p>	

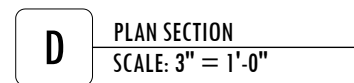
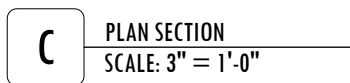

SkillsUSA

CALIFORNIA STATE CONTEST

ITEM:		WOOD END TABLE	
DATE:	APRIL	COMPETITION DATE:	2025
SCALE:	3" = 1'-0"	DWG #:	1B
DRAWN BY:	DW		

SPECIAL SPONSORS:



Duckworks
Millwork Solutions

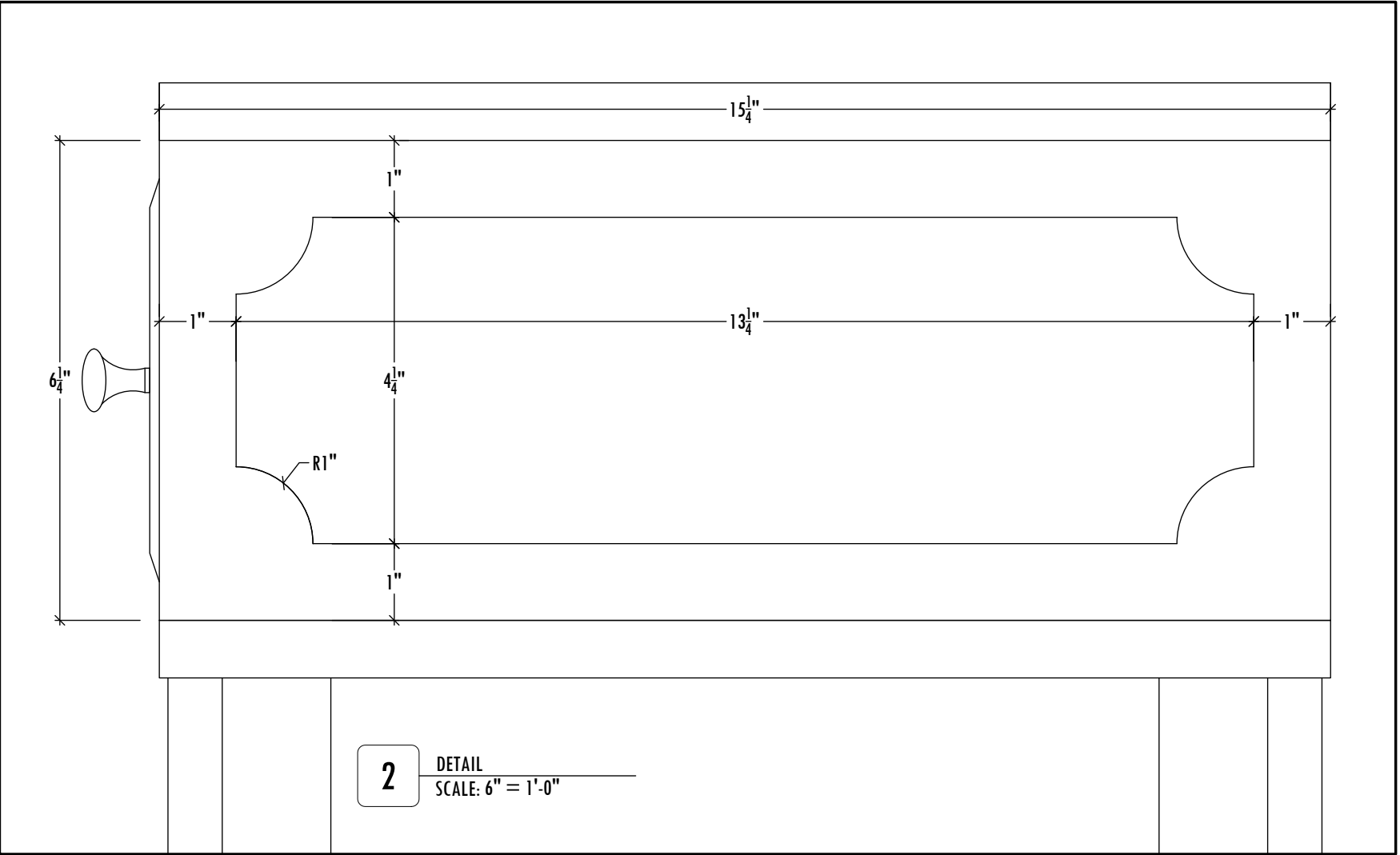
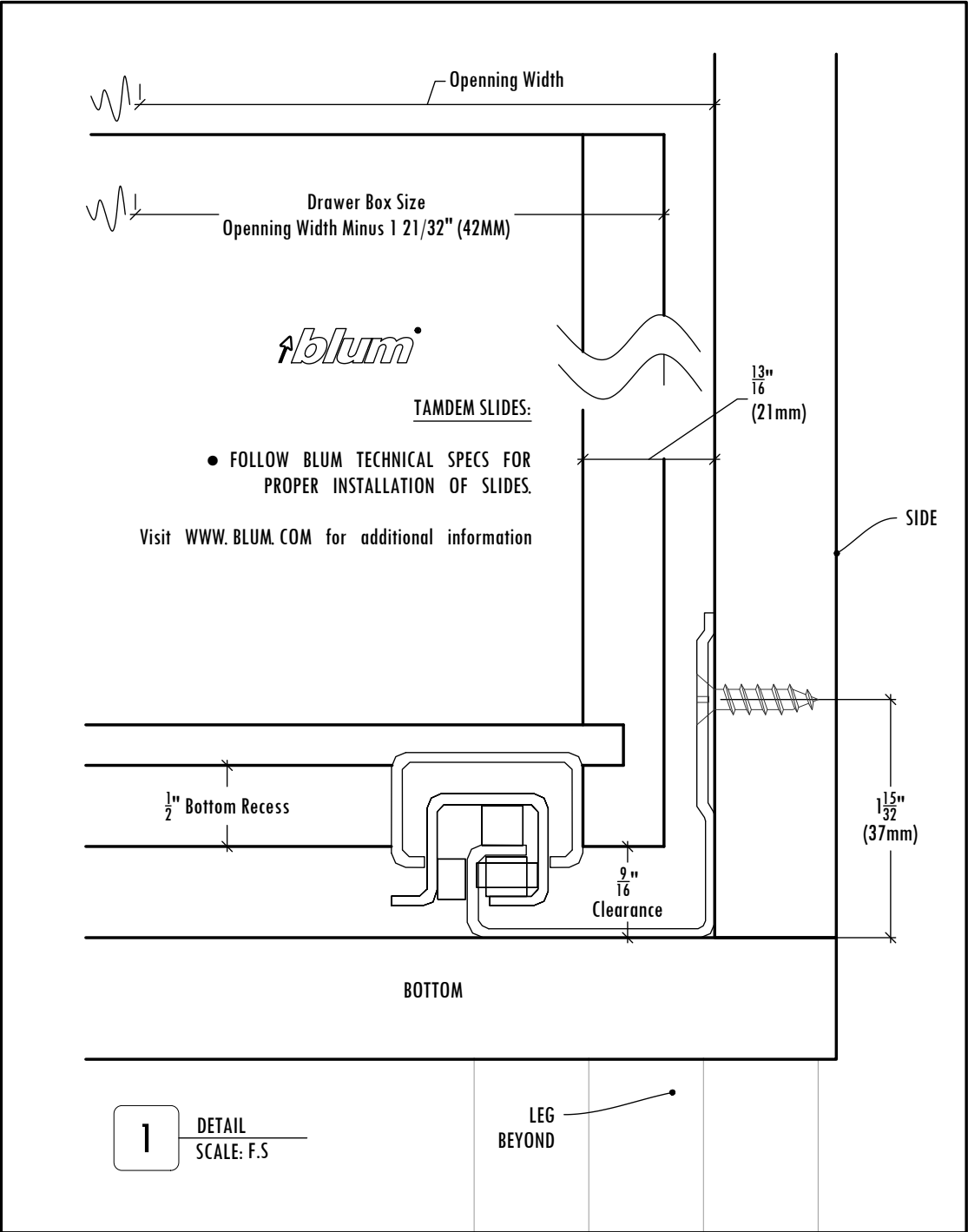

CONTESTANT #

SkillsUSA

CALIFORNIA

STATE CONTEST

ITEM: WOOD END TABLE	
DATE: APRIL	COMPETITION DATE: 2025
SCALE: F.S	DWG #: 1C
DRAWN BY: DW	
SPECIAL SPONSORS:	
<div><div>Duck</div><div>works</div><div>Millwork Solutions</div></div>	

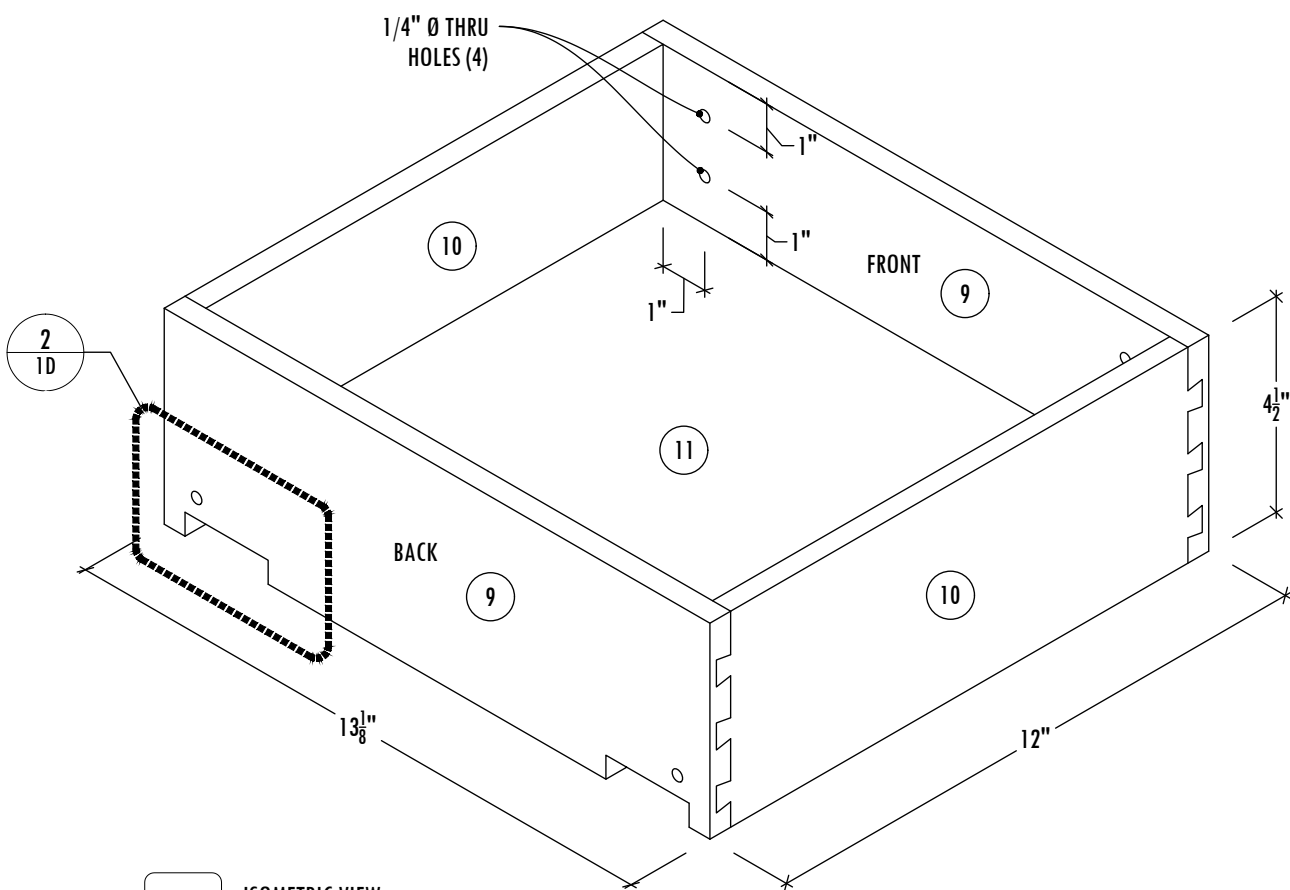

ISOMETRIC VIEW
SCALE: NTS

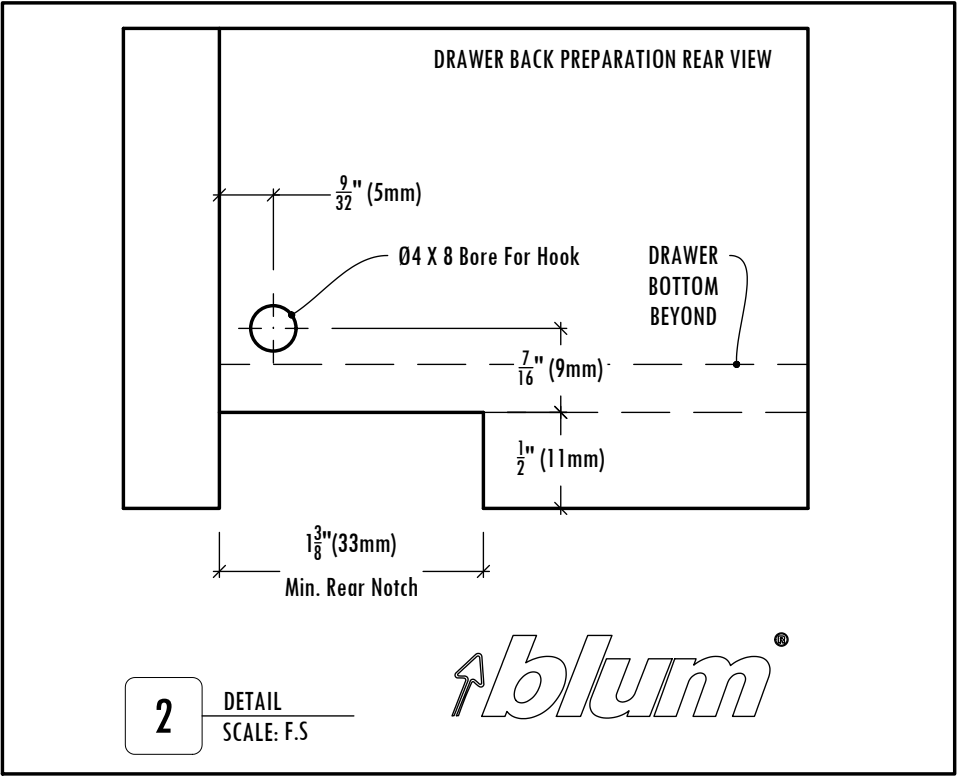

Drawer Box Kit Will be a Kit from
Drawer Box Specialties

CONTESTANT #

SkillsUSA

CALIFORNIA STATE CONTEST

ITEM: WOOD END TABLE	
DATE: APRIL	COMPETITION DATE: 2025
SCALE: AS SHOWN	DWG #: 1D
DRAWN BY: DW	

SPECIAL SPONSORS:

Duckworks
Millwork Solutions

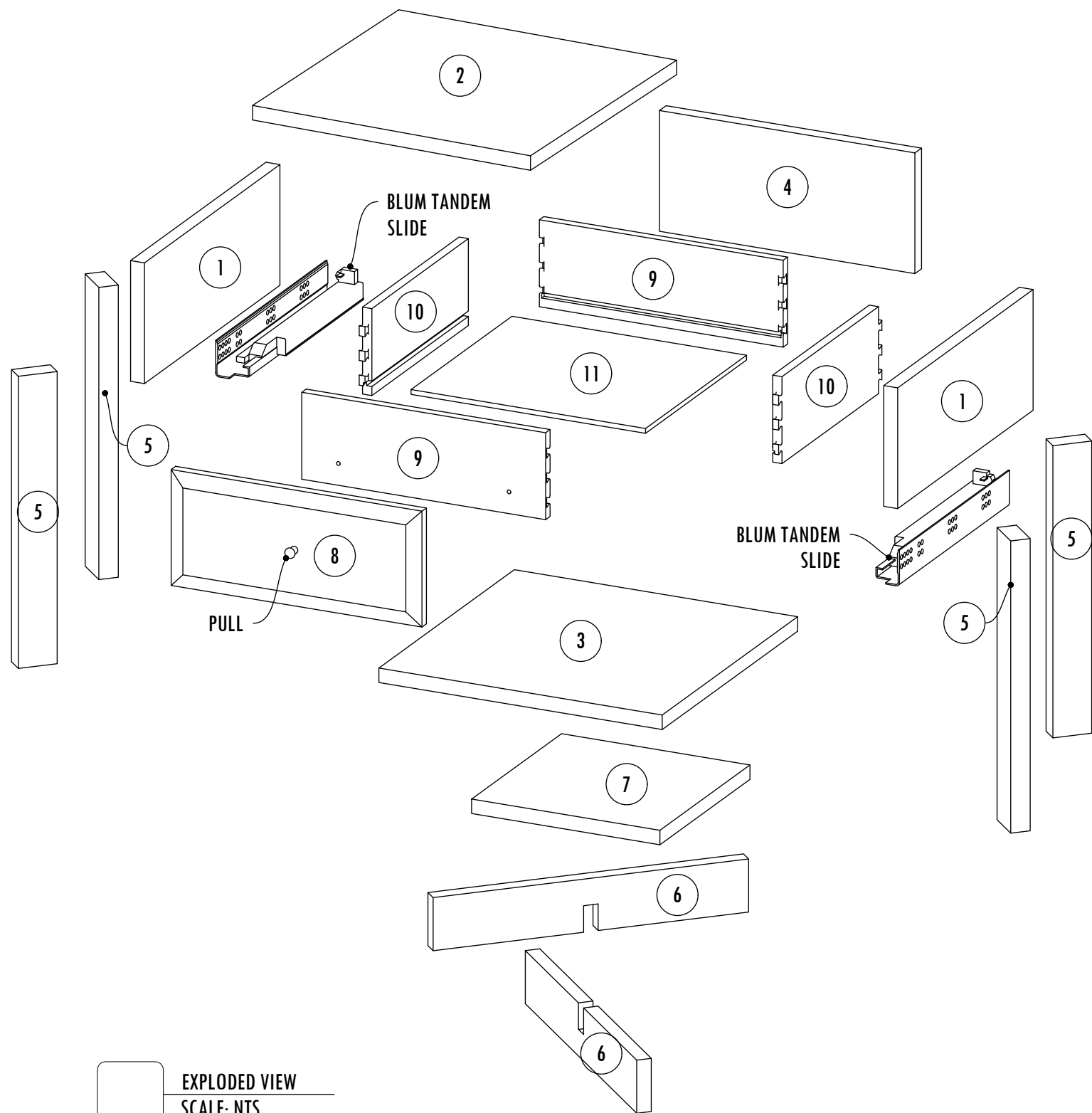

EXPLODED VIEW
SCALE: NTS

EXPLODED PARTS	
#	DESCRIPTION
1	SIDES
2	TOP
3	BOTTOM
4	BACK
5	LEGS
6	RAILS
7	DECK
8	DRAWER FRONT
9	DRAWER SUB-FRONT & BACK
10	DRAWER SIDES
11	DRAWER BOTTOM

CONTESTANT #

SkillsUSA
CALIFORNIA
STATE CONTEST

ITEM: WOOD END TABLE	
DATE: APRIL	COMPETITION DATE: 2025
SCALE: AS SHOWN	DWG #: 1E
DRAWN BY: DW	

SPECIAL SPONSORS:

Millwork Solutions

NOTES:

CUT LIST							
#	QTY	DESCRIPTION	MATERIAL	THICKNESS	WIDTH	LENGTH	NOTES
1		SIDES	RED OAK PLY	$\frac{3}{4}$ "			E.B. Ends
2		TOP	RED OAK PLY	$\frac{3}{4}$ "			E.B. All 4 Sides
3		BOTTOM	RED OAK PLY	$\frac{3}{4}$ "			E.B. All 4 Sides
4	1	BACK	RED OAK PLY	$\frac{3}{4}$ "			
5		LEGS	SOLID RED OAK	1"			
6		RAILS	SOLID RED OAK	$\frac{3}{4}$ "			Half Lap
7	1	DECK	RED OAK PLY	$\frac{3}{4}$ "			Drill for dowels
8	1	DRAWER FRONT	SOLID RED OAK	$\frac{3}{4}$ "			
9	2	DRAWER SUB-FRONT & BACK	BALTIC BIRCH PLY	$\frac{1}{2}$ "	$4\frac{1}{2}$ "	$13\frac{1}{8}$ "	
10		DRAWER SIDES	BALTIC BIRCH PLY	$\frac{1}{2}$ "	$4\frac{7}{16}$ "	$11\frac{11}{16}$ "	
11	1	DRAWER BOTTOM	BALTIC BIRCH PLY	$\frac{1}{4}$ "	$11\frac{1}{2}$ "	$12\frac{5}{8}$ "	

CONTESTANT #

FILL IN OPEN CELLS (5 POINTS EACH)
This portion of the competition is worth 110 of 1000 points.

KEEP FOR CONTEST

SkillsUSA

CALIFORNIA

STATE CONTEST

ITEM:

WOOD END TABLE

DATE:

APRIL

COMPETITION DATE:

2025

SCALE:

N/A

DWG #:

1F

DRAWN BY:

DW

SPECIAL SPONSORS:

Duckworks

Millwork Solutions

NOTES:

CUT LIST							
#	QTY	DESCRIPTION	MATERIAL	THICKNESS	WIDTH	LENGTH	NOTES
1		SIDES	RED OAK PLY	$\frac{3}{4}$ "			E.B. Ends
2		TOP	RED OAK PLY	$\frac{3}{4}$ "			E.B. All 4 Sides
3		BOTTOM	RED OAK PLY	$\frac{3}{4}$ "			E.B. All 4 Sides
4	1	BACK	RED OAK PLY	$\frac{3}{4}$ "			
5		LEGS	SOLID RED OAK	1"			
6		RAILS	SOLID RED OAK	$\frac{3}{4}$ "			Half Lap
7	1	DECK	RED OAK PLY	$\frac{3}{4}$ "			Drill for dowels
8	1	DRAWER FRONT	SOLID RED OAK	$\frac{3}{4}$ "			
9	2	DRAWER SUB-FRONT & BACK	BALTIC BIRCH PLY	$\frac{1}{2}$ "	$4\frac{1}{2}$ "	$13\frac{1}{8}$ "	
10		DRAWER SIDES	BALTIC BIRCH PLY	$\frac{1}{2}$ "	$4\frac{7}{16}$ "	$11\frac{11}{16}$ "	
11	1	DRAWER BOTTOM	BALTIC BIRCH PLY	$\frac{1}{4}$ "	$11\frac{1}{2}$ "	$12\frac{5}{8}$ "	

CONTESTANT #

FILL IN OPEN CELLS (5 POINTS EACH)
This portion of the competition is worth 110 of 1000 points.

SUBMIT TO JUDGE

SkillsUSA
CALIFORNIA
STATE CONTEST

ITEM: WOOD END TABLE	
DATE: APRIL	COMPETITION DATE: 2025
SCALE: N/A	DWG #: 1F-J
DRAWN BY: DW	

SPECIAL SPONSORS:
Duckworks
Millwork Solutions

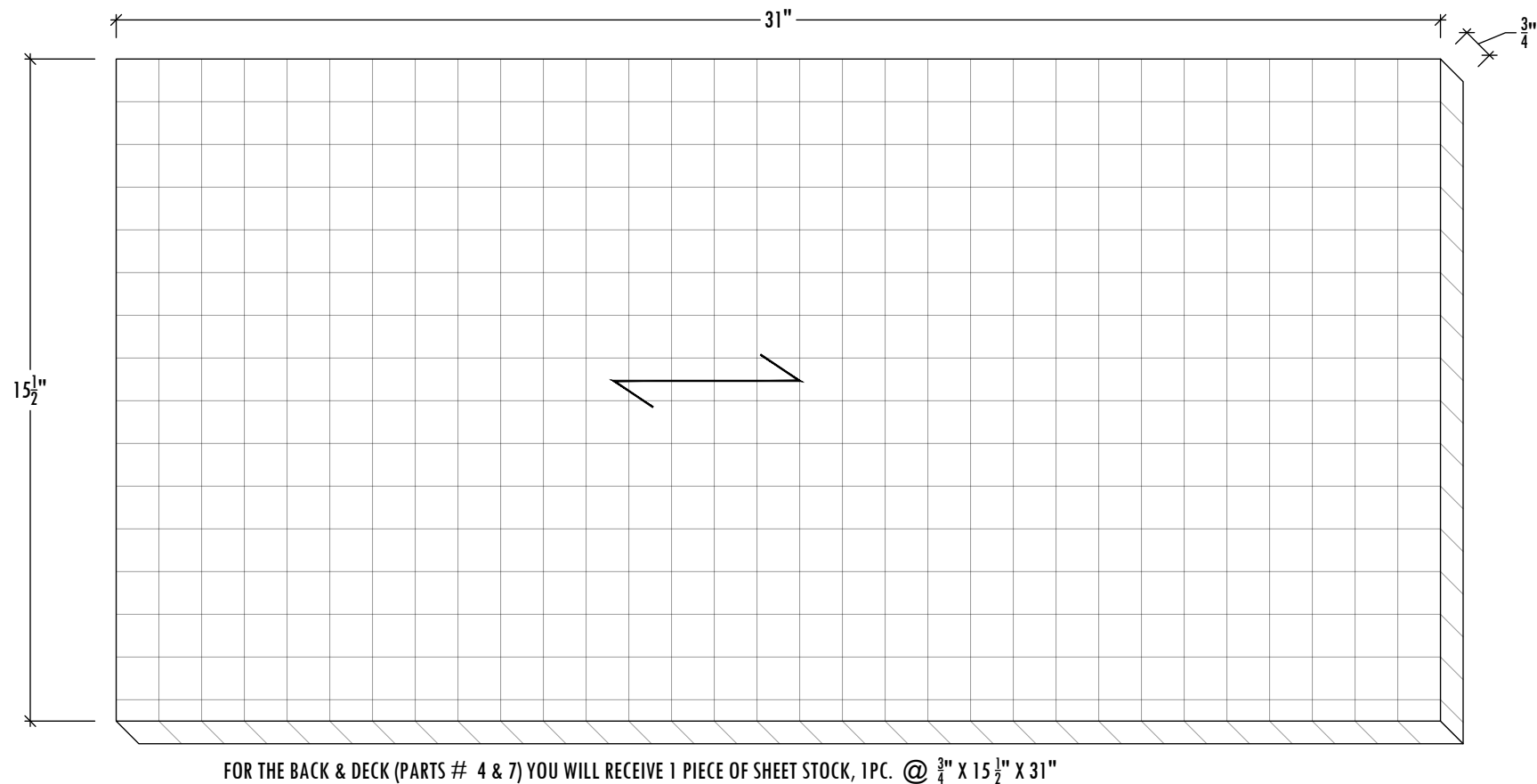

CONTESTANT #

MATERIAL LAYOUT INSTRUCTIONS

Once you've completed your Bill of Materials, lay out the parts on each corresponding piece of material. Do this by drawing a line vertically and/or horizontally to indicate saw cut. Label each piece with the part name and overall dimensions. Draw an "X" on any scrap pieces. Pay close attention to the grain direction of each piece.

This portion of the competition is worth 40 of 1000 points.

Note: Each square is scaled to 1" Squared.

KEEP FOR CONTEST

SkillsUSA

CALIFORNIA

STATE CONTEST

ITEM: WOOD END TABLE	
DATE: APRIL	COMPETITION DATE: 2025
SCALE: N/A	DWG #: LAYOUT A
DRAWN BY: DW	

SPECIAL SPONSORS:

Duck

works

Millwork Solutions

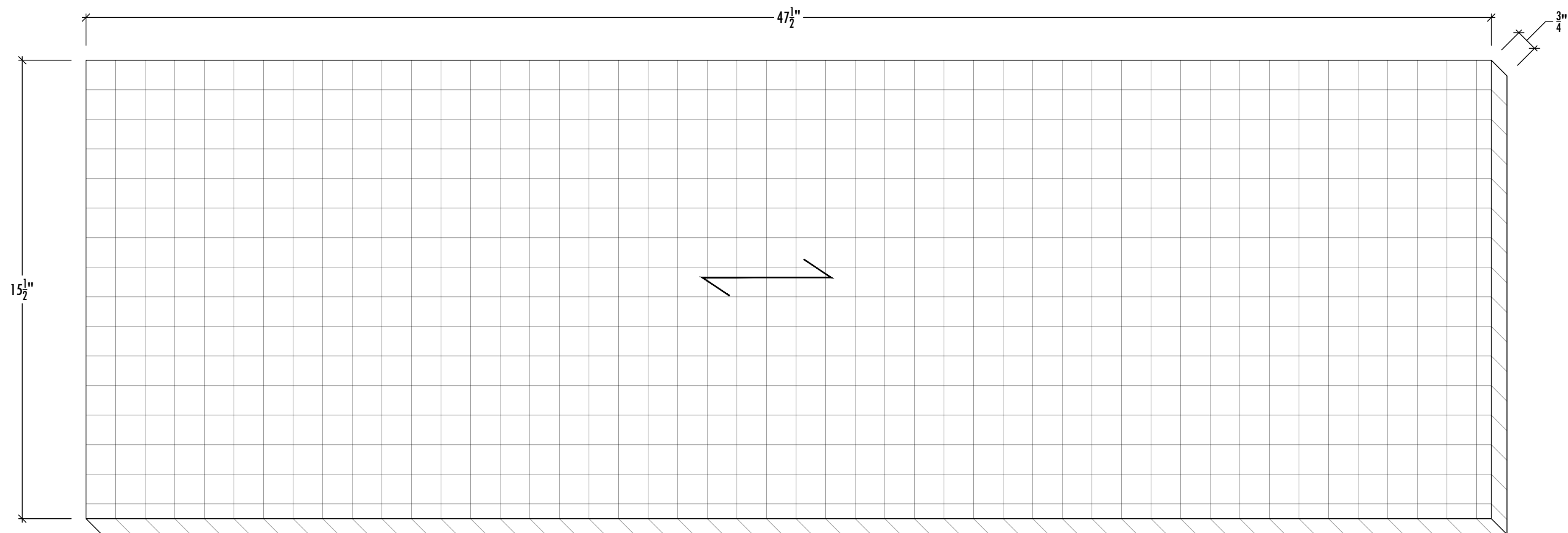

FOR THE SIDES, TOP & BOTTOM (PARTS # 1, 2 & 3) YOU WILL RECEIVE 1 PIECE OF SHEET STOCK, 1PC. @ $\frac{3}{4}$ " X $15\frac{1}{2}$ " X $47\frac{1}{2}$ "

CONTESTANT #

MATERIAL LAYOUT INSTRUCTIONS

Once you've completed your Bill of Materials, lay out the parts on each corresponding piece of material. Do this by drawing a line vertically and/or horizontally to indicate saw cut. Label each piece with the part name and overall dimensions. Draw an "X" on any scrap pieces. Pay close attention to the grain direction of each piece.

This portion of the competition is worth 40 of 1000 points.

Note: Each square is scaled to 1" Squared.

KEEP FOR CONTEST

SkillsUSA
CALIFORNIA
STATE CONTEST

ITEM: WOOD END TABLE	
DATE: APRIL	COMPETITION DATE: 2025
SCALE: N/A	DWG #: LAYOUT B
DRAWN BY: DW	

SPECIAL SPONSORS:
Duckworks
Millwork Solutions

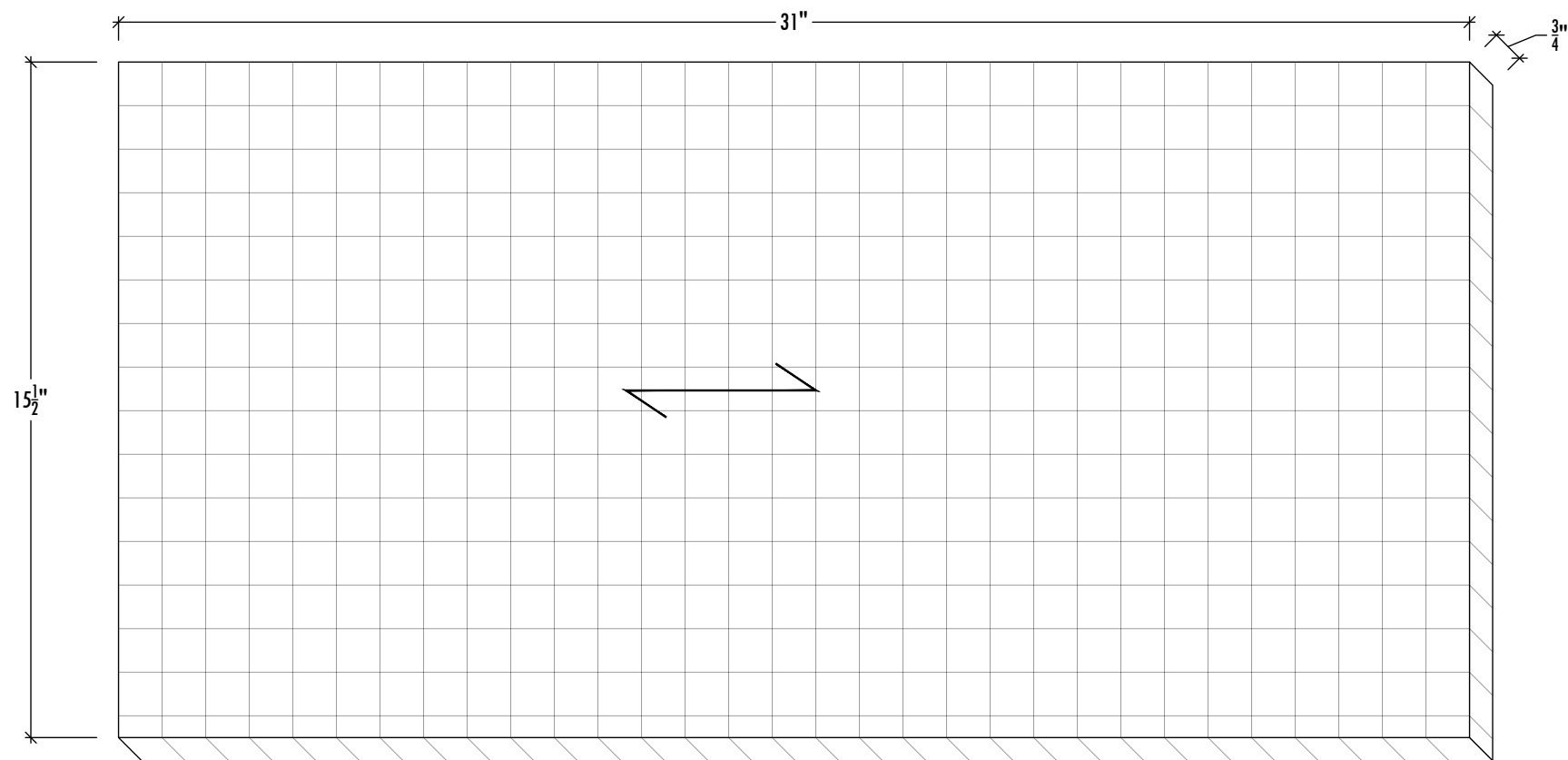

FOR THE BACK & DECK (PARTS # 4 & 7) YOU WILL RECEIVE 1 PIECE OF SHEET STOCK, 1PC. @ $\frac{3}{4}$ " X $15\frac{1}{2}$ " X 31"

CONTESTANT #

MATERIAL LAYOUT INSTRUCTIONS

Once you've completed your Bill of Materials, lay out the parts on each corresponding piece of material. Do this by drawing a line vertically and/or horizontally to indicate saw cut. Label each piece with the part name and overall dimensions. Draw an "X" on any scrap pieces. Pay close attention to the grain direction of each piece.

This portion of the competition is worth 40 of 1000 points.

Note: Each square is scaled to 1" Squared.

SUBMIT TO JUDGE

SkillsUSA
CALIFORNIA
STATE CONTEST

ITEM: WOOD END TABLE	
DATE: APRIL	COMPETITION DATE: 2025
SCALE: N/A	DWG #: LAYOUT A
DRAWN BY: DW	

SPECIAL SPONSORS:
Duckworks
Millwork Solutions

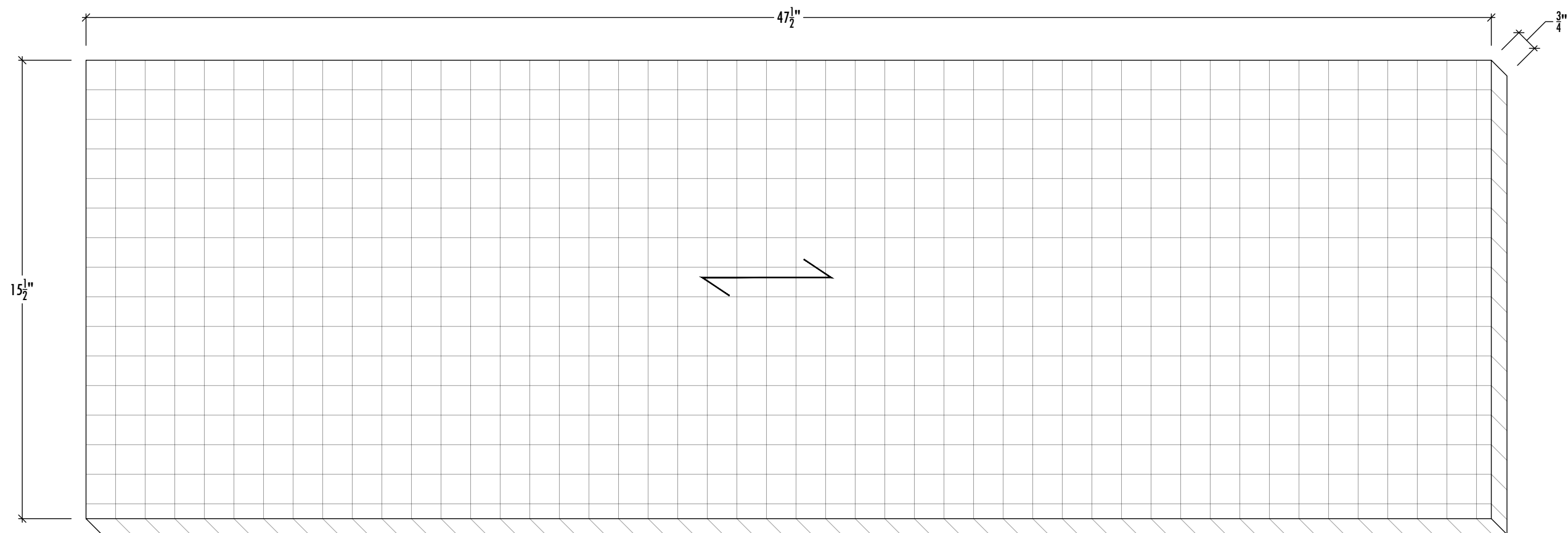

FOR THE SIDES, TOP & BOTTOM (PARTS # 1, 2 & 3) YOU WILL RECEIVE 1 PIECE OF SHEET STOCK, 1PC. @ $\frac{3}{4}$ " X $15\frac{1}{2}$ " X $47\frac{1}{2}$ "

CONTESTANT #

MATERIAL LAYOUT INSTRUCTIONS

Once you've completed your Bill of Materials, lay out the parts on each corresponding piece of material. Do this by drawing a line vertically and/or horizontally to indicate saw cut. Label each piece with the part name and overall dimensions. Draw an "X" on any scrap pieces. Pay close attention to the grain direction of each piece.

This portion of the competition is worth 40 of 1000 points.

Note: Each square is scaled to 1" Squared.

SUBMIT TO JUDGE

SkillsUSA
CALIFORNIA
STATE CONTEST

ITEM: WOOD END TABLE	
DATE: APRIL	COMPETITION DATE: 2025
SCALE: N/A	DWG #: LAYOUT B
DRAWN BY: DW	

SPECIAL SPONSORS:
Duckworks
Millwork Solutions